

PLAN OF THE STAND LAYOUT

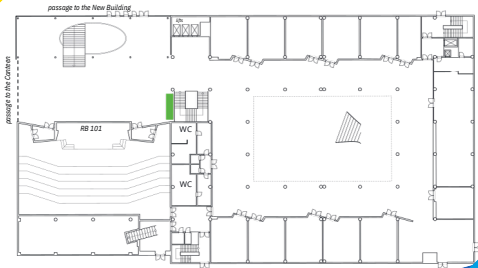

PLEASE NOTE THAT THE BORROWER IS FULLY RESPONSIBLE FOR THE BORROWED ITEMS FOR THE ENTIRE PERIOD OF BORROWING AND UNDERTAKES TO USE THEM WITH THE UTMOST CARE AND PROTECTION AGAINST DAMAGE OR LOSS. THANK YOU.

Campus of VŠE Žižkov Rajská building



 Allowed area for rack/roll-up placement

Campus of VŠE Žižkov Old building

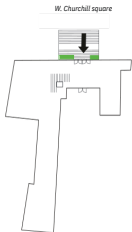

Campus of VŠE Žižkov Italská Building



Campus of VŠE Žižkov New building

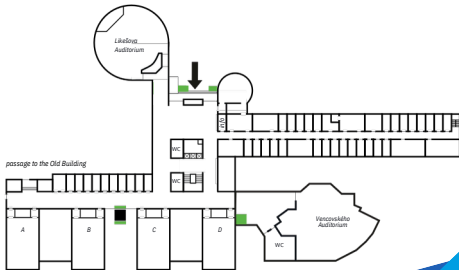

Allowed area for rack/roll-up placement